

- Insert, lift the lever up, and inflate.
- Press the lever down then pull back to disengage.

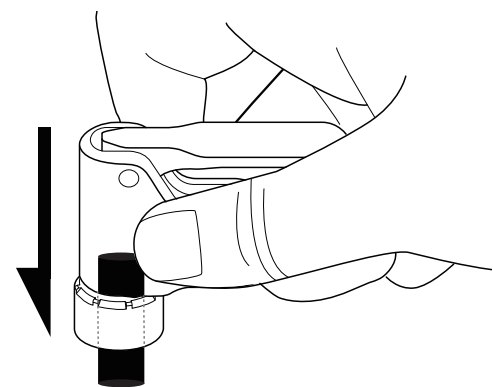
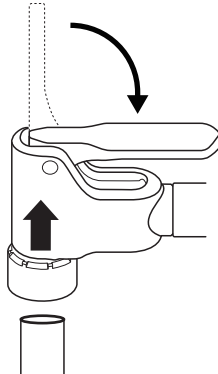
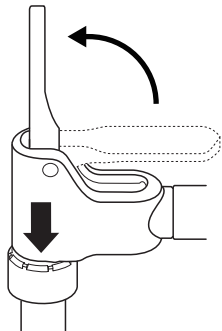
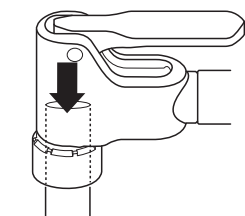
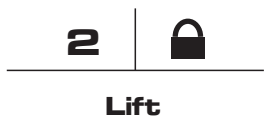

Caution:

- Please ensure the valve head is parallel with the valve and pressed all the way down when inserted.
- Please refrain from lubrication attempts.

Flick-It is compatible with:

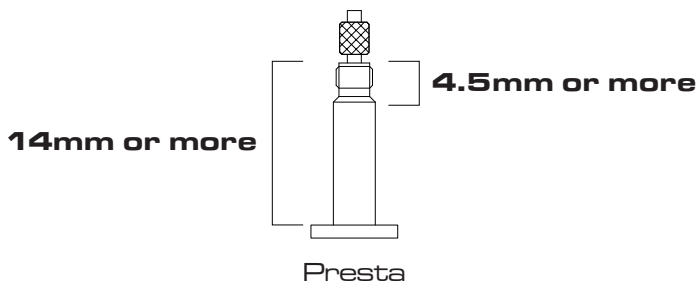

Flick-It Spare Parts:

- Lift the lever up to push the parts out for easier access.

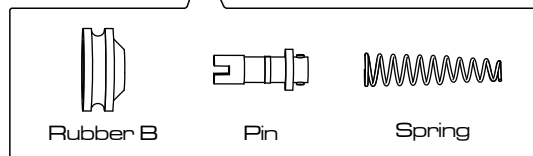
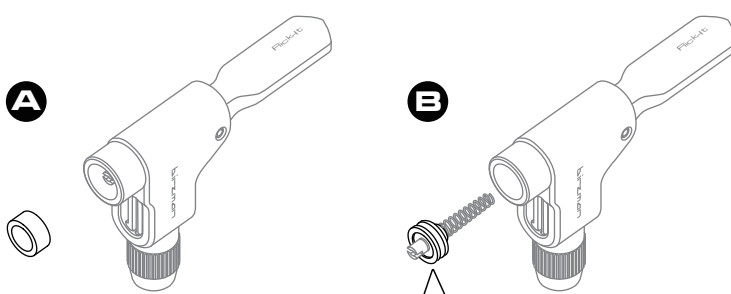
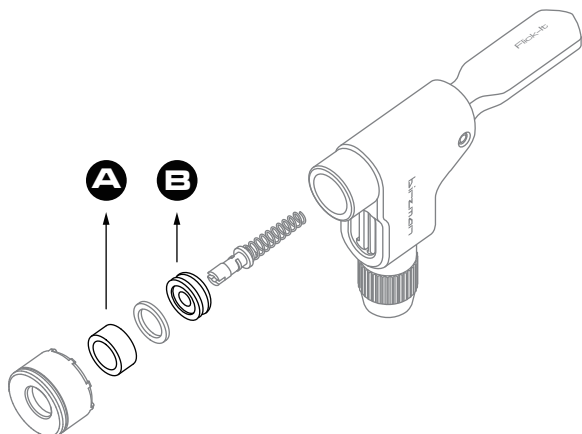

- Join the wider side of the spring with the pin.
- Insert the pin through Rubber B.
- Place all into the housing and push down tightly.

The flatter side of Rubber B should be facing outwards.