

## Instruction Manual

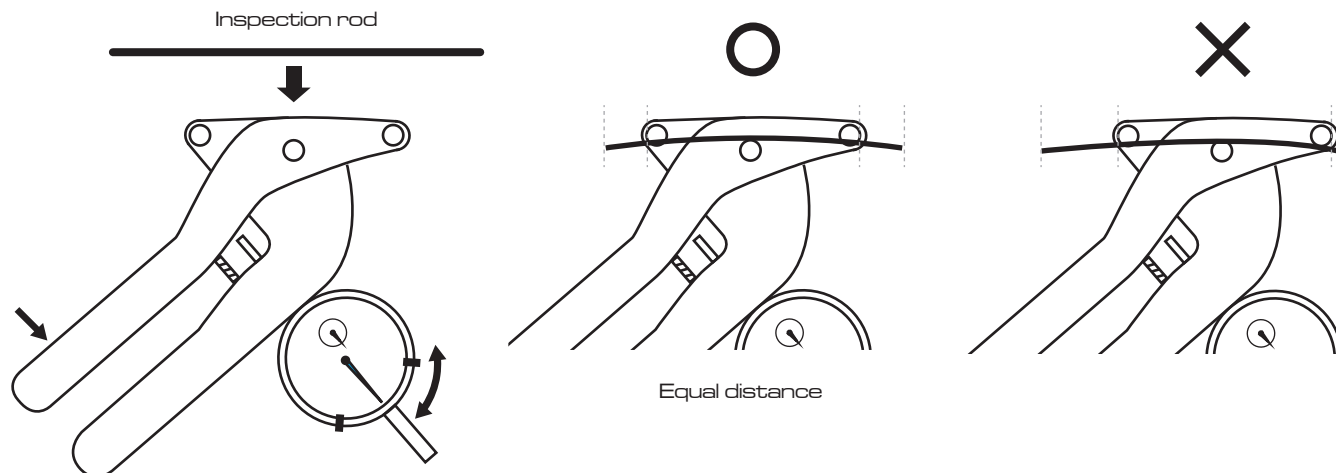

Please reset the dial gauge with the inspection rod according to the Precision Range before each use.

Manufactured Date	Precision Range (mm)
	-

## Conversion Chart

Spoke Tension (N)	Ø2.0mm	Ø1.8mm	Ø1.5mm	Spoke Tension (N)	Ø 2.0mm	Ø1.8mm	Ø1.5mm
	Measured Value (mm)				Measured Value (mm)		
600	1.76	1.43	0.65	1400	2.59	2.28	1.58
700	1.86	1.53	0.76	1500	2.67	2.35	1.65
800	1.98	1.67	0.89	1600	2.75	2.45	1.72
900	2.1	1.82	1.05	1700	2.81	2.51	1.78
1000	2.22	1.92	1.15	1800	2.86	2.57	1.86
1100	2.31	2.02	1.28	1900	2.92	2.63	1.92
1200	2.39	2.12	1.38	2000	2.98	2.69	1.98
1300	2.49	2.22	1.48				

### Note :

Please check with rim manufacturer for specific spoke tension settings.

1 N = 1 kg m/s<sup>2</sup>; 10 N ≈ 1 kp; 10 N ≈ 1 kgf; 1 N ≈ 0,2248 lbf