

**Note:**

- For the proper maintenance of your tools, please apply a rust preventive oil regularly.
- All tools should be stored in a dry environment.

**Lockring Socket Shimano® HG**

- ½" Dr.
- Features a Ø5mm center pin
- Compatible with Shimano® HG & SRAM® Cassettes; Shimano® Center Lock, or other similar 12-spline Ø23.4mm lockrings.

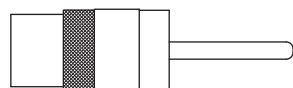

**Lockring Socket Shimano® MF & Campagnolo®**

- ½" Dr.
- Compatible with Shimano® MF Freewheels, or other similar 12-spline Ø22.7mm lockrings.
- Also compatible with Campagnolo® Cassettes, BB and Rotors.

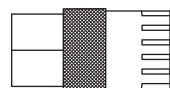

**B.B. Socket Shimano® Cartridge**

- ½" Dr.
- Compatible with Shimano® Cartridge, or other similar 20-notch Ø31.6mm bottom brackets.

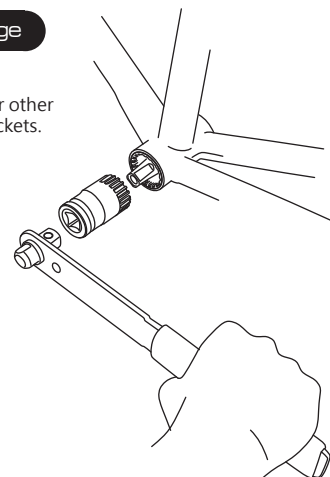
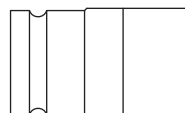

**B.B. Socket Hollowtech II™**

- ½" Dr.
- Compatible with Shimano® Hollowtech II™ or other 16-notch Ø44mm external bearing bottom bracket cups and 16 notch rotor disc lockrings.
- Fits Shimano® BB Tool Adaptors TL-FC24 and TL-FC25.

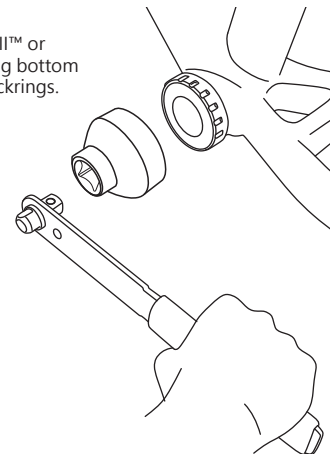
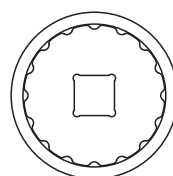

**Hex Sockets 14 & 15mm**

- ½" Dr.



**Bit Socket T30**

- ½" Dr.

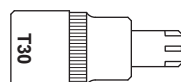

**Socket Wrench**

- Compatible with ½" Dr. sockets.



**Chain Whip**

- Compatible with 7-12 speed cassettes.

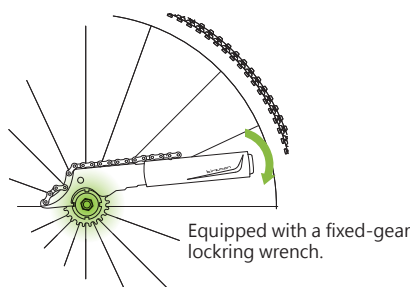
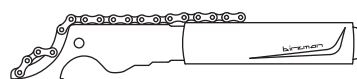

**Pedal Wrench**

- 15mm

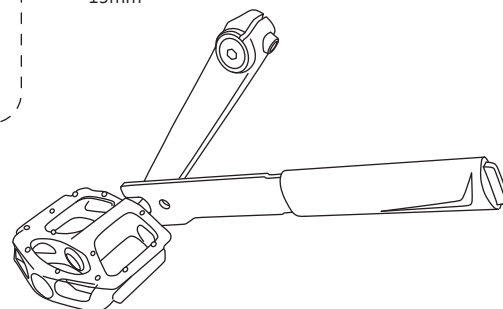

**Chainring Nut Wrench**

- Immobilises slotted chainring nuts when installing or removing chainring bolts.
- Features 9 & 10mm hex wrenches.

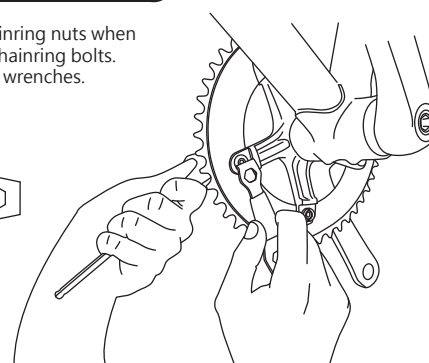

**Radio Pliers**

- 6"
- Five different crimping zones, including a crimper for cable end caps.
- Features a forming hole for reforming housing ends and ferrules.

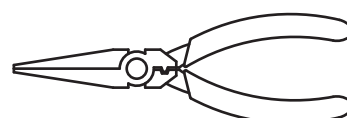

**Note:**  
This tool is only for the purpose of reforming.  
For harder materials, please use the Birzman Cable Cutter.

**Diagonal Pliers**

- 6"

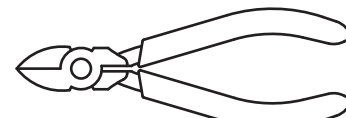

**Note:**  
This tool is only for the purpose of reforming.  
For harder materials, please use the Birzman Cable Cutter.

**Disc Brake Piston Press**

- Features a wedge-shaped end of 23mm in width.

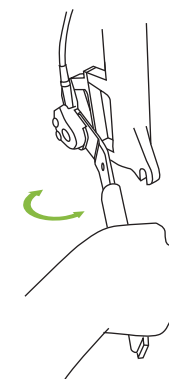

**Rotor Truing Fork**

- Features two laser cut slots offering different leverage ratios for precise adjustments.
- An ergonomically designed angle provides precise grip for controlled adjustments.

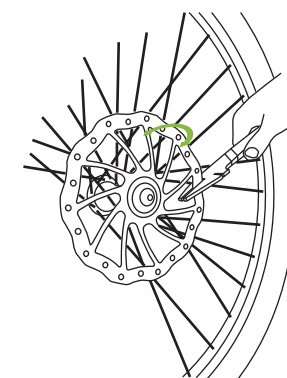

**Crank Arm Cap Tool**

- Compatible with Shimano® cranksets or other 8-notch crank arm caps / SRAM®, RaceFace® or other 16mm internal hex crank arm caps.
- Features 6mm hex holes on both sides for use with hex wrenches.

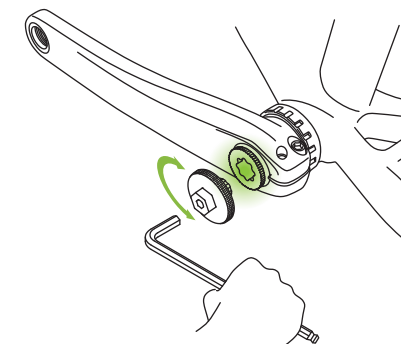

**Disc Brake Gap Indicator**

- Creates an equal space between disc brake pads and rotor for calliper adjustments.

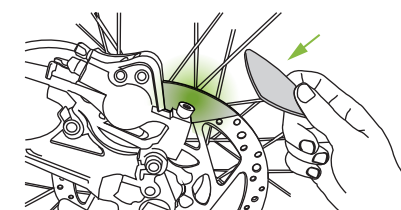

Instructions of Use:  
1. Loosen the bolts connecting calliper to fork.  
2. Place the tool on the rotor and slide it between the disc brake pads.  
3. Apply the brakes, adjust the calliper accordingly then tighten the bolts.  
4. Release the brakes, turn the rotor and allow the tool to slide out.

**Universal Crank Puller**

- Compatible with ISIS® Drive Octalink® and square tapered crank arms.

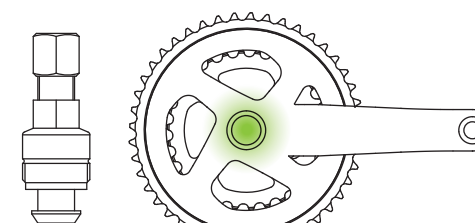

- Compatible with ISIS® Drive and Octalink®.

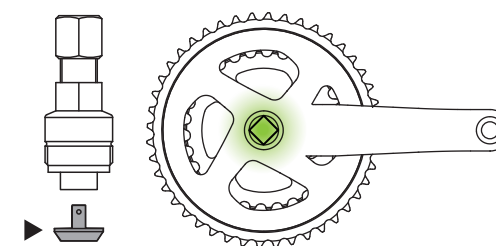

- Remove nut for use with square tapered crank arms.

**Cable Cutter**

- Features an integrated awl for restoring cut housing ends.

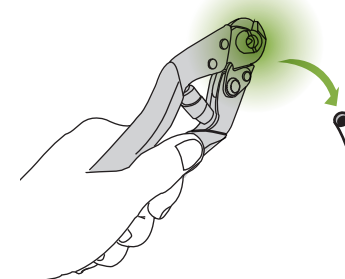

**Link Pliers**

- For use when assembling and removing masterlinks.

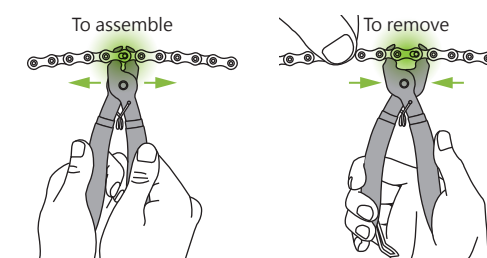

**Note:**

- For the proper maintenance of your tools, please apply a rust preventive oil regularly.
- All tools should be stored in a dry environment.

**Torx® Key Set**

- 7 PCS: T10 / T15 / T20 / T25 / T27 / T30 / T40
- Tamper-resistant Torx® keys with hollowed tips for use with standard and tamper-resistant security fasteners.

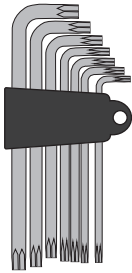

**Hex Key Set**

- 9 PCS: 1.5 / 2 / 2.5 / 3 / 4 / 5 / 6 / 8 / 10mm

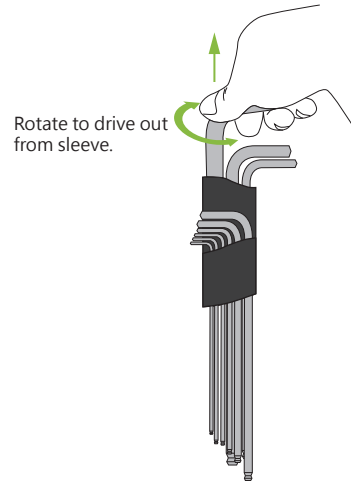

**Chain Rivet Extractor**

- Compatible with 5-12 speed; 1/2" and 1/8" single speed chains.
- Adjustable cradle system securely fits chains of different sizes, allowing the tool pin to drive out the rivet quickly and securely.
- S2 steel replaceable rivet pin.

**Note:**

Please ensure that the rivet pin of the tool is in line with the chain pin.

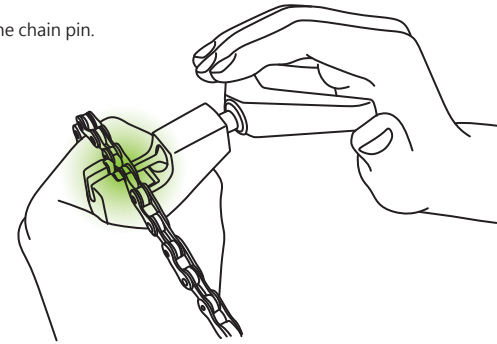
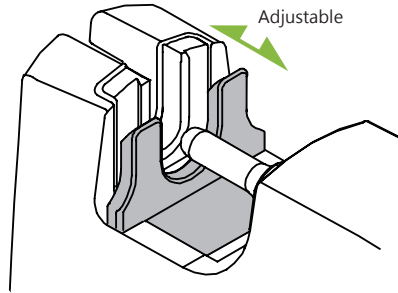

**Chain Wear Indicator**

- Checks the degree of chain wear and stretch.
- Indications: 0.5%, 0.75% and 1%.
- Compatible with derailleur chains from single to 12 speed.
- CNC machined stainless steel.

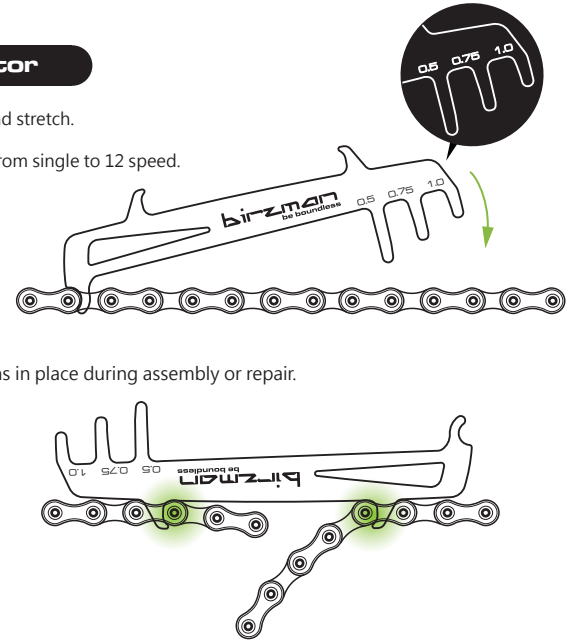

- Integrated chain hooks hold chains in place during assembly or repair.

**Bladed Spoke Grip**

- Compatible with 1.0-2.0mm wide bladed spokes.

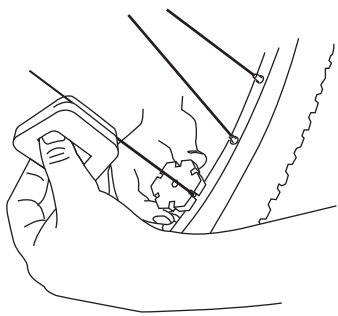

**Spoke Wrench**

- Compatible with 12G-15G and Shimano® 4.3/4.4 spoke nipples.

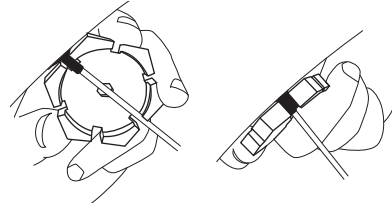

- Features a 5mm hex hole in the center for use with a hex wrench to optimize leverage and control.

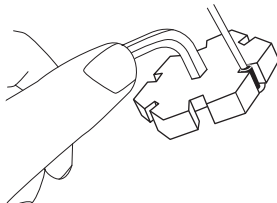

**Valve Core Tool**

- Compatible with both Presta and Schrader valve cores.
- Features a 5mm flat wrench for removing Presta valve extenders.

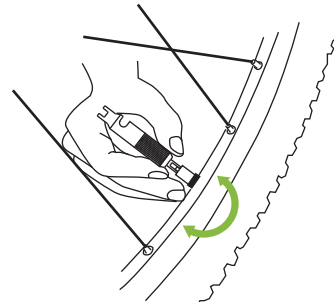
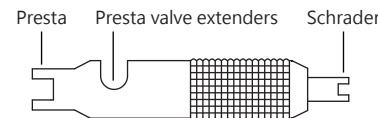

**Tire Lever Set**

- Features integrated air release knob for use on Schrader valves.

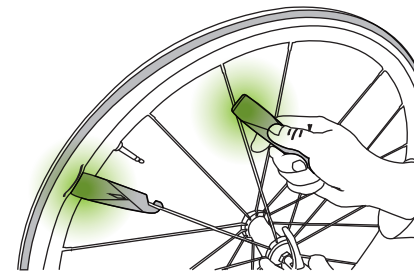

**Instructions of Use:**

1. Insert the flat end of one tire lever into the rim and secure the hook end on the spoke.
2. Use the other tire lever to release the tire from the rim.

**Threadless Nut Setting Tool**

- For use on installing star-fangled nuts on 1" and 1 1/4" threadless headset systems.
- Features an integrated guide with pre-set range to precisely set a star-fangled nut straight and to a proper depth into the steerer tube.

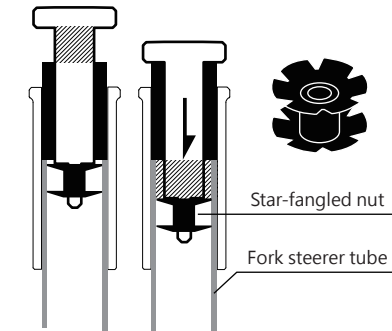

**Instructions of Use:**

1. Place the star-fangled nut on the pin of the tool.

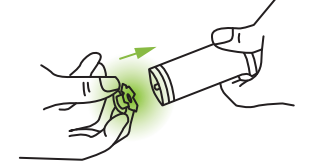

2. Fix the tool onto the steerer tube, then tap the head of the tool with a Dead Blow Hammer until the nut is in place.

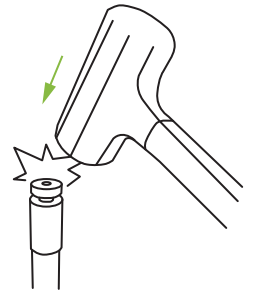

**Screwdriver Crosshead #2**

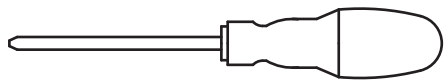

**Screwdriver Flathead 5.5**

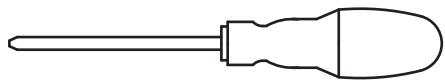

**File**

- 6" half-round design - rounded on one side, flat on the other.



**Combination Wrench**

- Double-ended, 8 & 10mm.

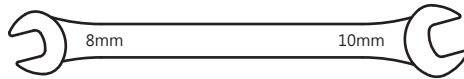

**Shifting Spanner**

- Jaws open to 33mm.
- Laser engraved measurement scale.

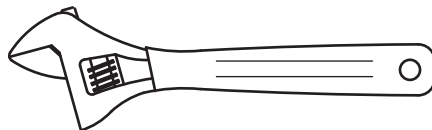

**Dead Blow Hammer**

- Features an anti-slip rubber grip.
- Hardness: (83A~86A)

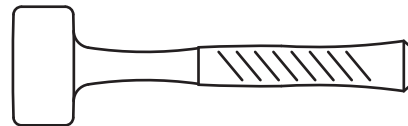

**Tape Measure**

- Features both Metric and Imperial readings up to 3m/10ft.
- Equipped with an 'auto-lock' function with two lock-release buttons.

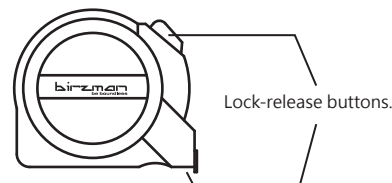

**Threadless Saw Guide**

- Guides the blade to ensure a precise cut on tubes ranging from 1 to 1 1/4".
- Adjustable spacers to accommodate both 1.2mm (steel) and 2mm (carbon) saw blades.

